

MITCHELL & BROWN

Quick Start Guide

JB-551811FSM4K

Customer Helpline: 01204 377693

1 Insert the batteries into the Remote Control

Insert two **AAA/R3** or equivalent type batteries inside. Observe the correct polarity (+/-) when inserting batteries and replace the battery cover.



2 Connect the antenna to your TV

REAR BOTTOM OF THE TV

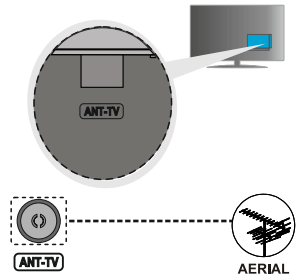

3 Connect the TV to the mains socket

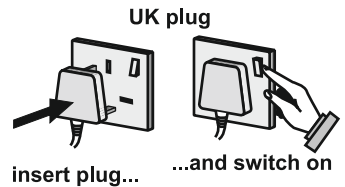

4 To switch the TV on

Connect the power cord to the mains socket. Then the standby LED lights up.

To switch on the TV from standby mode either;

1. Press the **Standby** button, a numeric button or **Programme + / -** button on the remote control.
2. Press the **Standby** button on the TV.

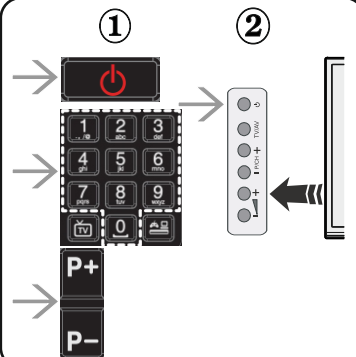

5 HDMI input

PLEASE ENSURE BOTH UNITS ARE SWITCHED OFF BEFORE CONNECTING. Use a HDMI to HDMI cable to connect the two units together. To select the HDMI input, press the **Source** button on the remote control. Each time it is pressed the on-screen menu confirms your selection.



To HDMI connection
on the device



6 Auto Setup procedure

When turned on for the first time, the language selection screen is displayed. Select the desired language and press **OK**.

On the next screen, set your preferences using the directional buttons.

Note: Depending on the **Country** selection you may be asked to set and confirm a PIN at this point. The selected PIN cannot be 0000. You have to enter it if you are asked to enter a PIN for any menu operation later.

About Selecting Broadcast Type

Digital Aerial: If aerial broadcast search option is turned on, the TV will search for digital terrestrial broadcasts after other initial settings are completed.

You can activate **Store Mode** option at this point. This option is intended only for store use. It is recommended to select **Home Mode** for home use.

Press **OK** button on the remote control to continue and the **Network Settings** menu will be displayed. Please refer to the next section about internet connection on the next page to configure a wired or a wireless connection. After the settings are completed press **OK** button to continue.

After the initial settings are completed TV will start to search for available broadcasts of the selected broadcast types. The **Edit Channel List** menu will be displayed when the search is completed. You can edit the channel list according to your preferences or press the **Menu** button to quit and watch TV.

While the search continues a message may appear, asking whether you want to sort channels according to the LCN(*). Select Yes and press **OK** to confirm.

(* LCN is the Logical Channel Number system that organizes available broadcasts in accordance with a recognizable channel number sequence (if available).

Note: Do not turn off the TV while initializing first time installation. Note that, some options may not be available depending on the country selection.

7 Connect your TV to the Internet

Connectivity feature allows you to connect your TV to the home network wired or wireless. You can use this networking system to connect to the Portal or to access photo, video and audio files that are stored on a Media server connected to the network and play/display them on the TV.

If you want, you can use wired connection type and add your TV to your home network by connecting it to the modem/router via a LAN cable (not supplied) as illustrated.

Press **Menu** button to open main TV menu. Select **System>Options** by using the directional buttons and press **OK** to enter. Highlight **Network Settings** and press **OK**. While **Network Type** is highlighted, press Left or Right buttons to select connection type. Wired connection will be established automatically. If wireless connection is selected, the TV will search for the available wireless networks and list them when finished. Select one and press **OK** button to connect. If the wireless network is password protected you should enter the correct code to access the network. Once you have established a wireless connection, this will be saved and you shouldn't enter the password to connect to the same wireless network again. You can delete the saved Wi-Fi profile any time. If **First Time Installation** is performed, this profile will be deleted as well.

Press **Internet** button -  on the remote to access internet portal, while your TV is connected. You can access a wide range of applications and services, using the internet portal feature of your TV.

Note: The appearance of the **Internet** button on your remote may differ according to the remote type supplied with your TV. Please check the remote overview page in the instruction manual. Portal page content is subject to change at any given time without prior notice.

Nero MediaHome software download link: <http://www.nero.com/mediahome-tv>.

Refer to the instruction manual for more details.

Wireless Connection

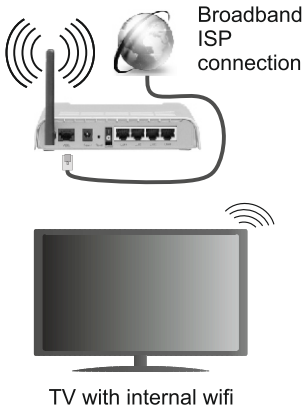

Wired Connection

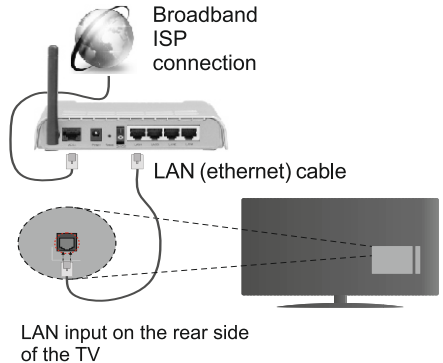

50373089